

SU 695

**FLUX CORED
SELF-SHIELDED
WELDING TORCH**



*Long Compact body,
High Impact Resistant Cable,
Electrical & Thermal Insulated,*

*Aluminum Hand Protection,
Cable With High Durability,
Replaceable Liner,*

*Rotatable Body,
Special Nozzles for Pipe
Welding.*

**Torch Developed
for welding Process
Using Wire without
Protective Gas**

Duty Cycle

600 A

40%

1,6 a 3,2

Wire Diameter (mm)

SUMIG 

SU 695

FLUX CORED SELF-SHIELDED WELDING TORCH

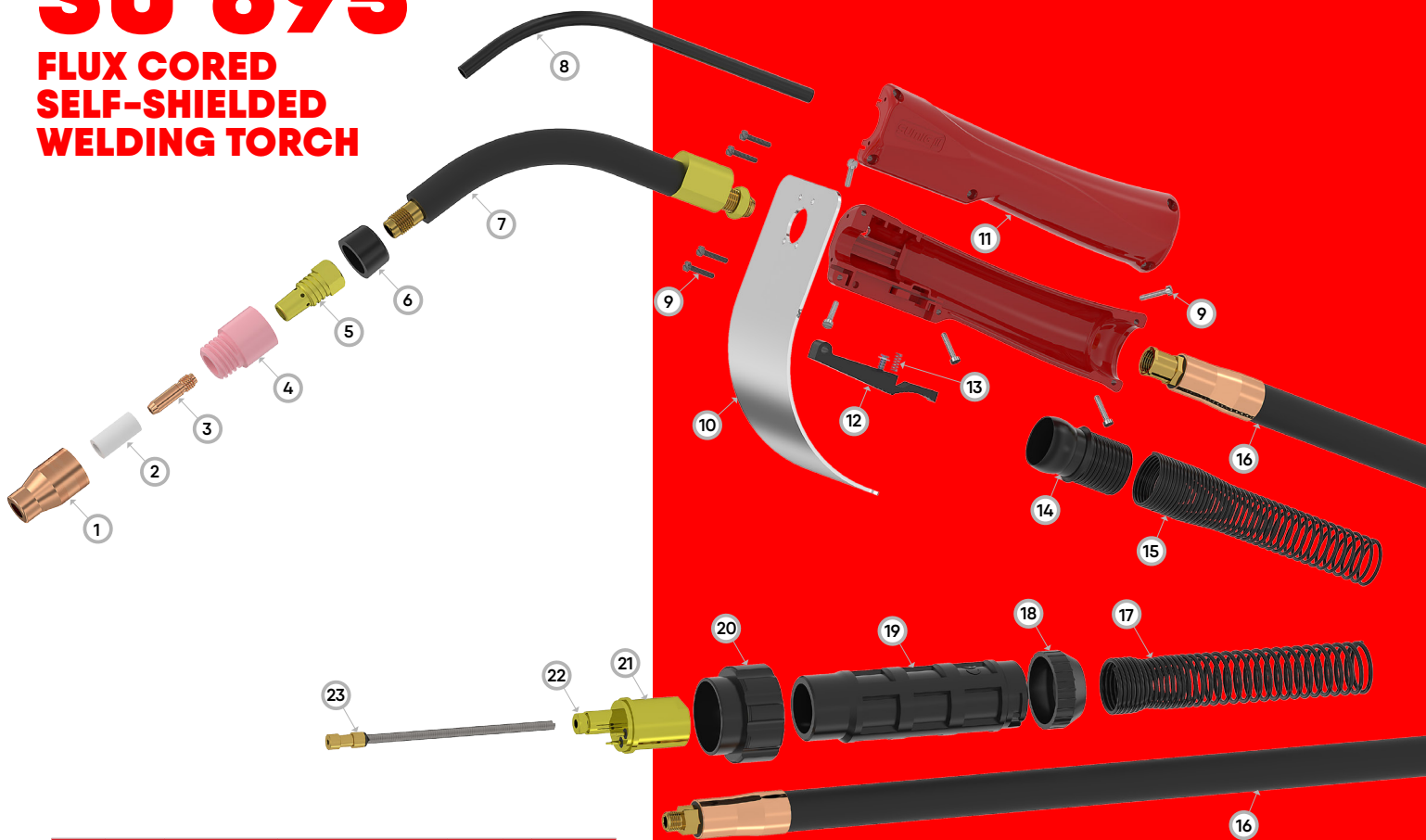

SU 695 - Flux Cored Self-Shielded Welding Torch

0500.7034	SU 695 - Flux Cored Self-Shielded Welding Torch	3,0 m
0500.7030		5,0 m

Pos.	Code	Description	
01	0500.1491	Nozzle	
02	0500.1490	Ceramic Nozzle Insulation	
03	0500.1895	Contact Tip M8 1,6 mm	
04	0500.1489	Ceramic Support	
05	0500.1772	Gas Diffuser	
06	0500.2644	Rubber Gas Diffuser Insulator	
07	0500.1585	Torch Body	
08	0500.1789	Torch Body Steel Liner	
09	0500.1106	Rear Screw	
10	0502.2044	Handle Protector	
11	0502.1899	Torch Handle	
12	0502.1429	Medium Torch Trigger	
13	0500.1135	Trigger Spring	
14	0502.1448	Suporte Giratório do Punho	
15	0502.1456	Front Cable Spring	
16	0500.1905	Current Cable	5,0 m
	0502.2349		3,0 m
17	0500.1135	Rear Cable Spring	
18	0500.1426	Euro Connector Spring Nut	
19	0502.1482	SU 695 Connector Support	
20	0500.1029	Euro Connector Nut	
21	0500.1856	Male Connector	
22	0500.2603	Steel Liner Nut	
23	0502.1111	Steel Liner 1,6/2,0 mm	5,5 m
	0502.1813		3,0 m

